



**VENCO
VENTURO**

INDUSTRIES LLC

VC500FB

**MFCAA
INSTALLATION & OWNER'S MANUAL**

TABLE OF CONTENTS

VC500FB OWNER'S MANUAL

<u>SECTION 100</u>	<u>DESCRIPTION & SPECIFICATIONS</u>
CEV146	DIMENSIONS AND CAPACITIES
CEV162	WIRE ROPE & HOOK SPECIFICATIONS
<u>SECTION 150</u>	<u>SAFETY</u>
CE-044	CRANE SAFETY AND HAZARDS
CEV147	DECAL DRAWINGS & LIST
<u>SECTION 200</u>	<u>INSTALLATION</u>
CEV155	MOUNTING & CAPACITY INFO.
CE-022	WIRING DIAGRAM
CEV156	ASSEMBLY; WIRE ROPE INSTALLATION.
CE-075	FOLDING BOOM STORAGE
CEV150	OPERATING INSTRUCTIONS
<u>SECTION 400</u>	<u>REPLACEMENT PARTS</u>
CEV160	REPLACEMENT PARTS DWG
CEV161	REPLACEMENT PARTS LIST
CE-055	REPLACEMENT PARTS DWG & LIST; WINCH
CEV157	DECAL LOCATIONS
CEV158	KIT; FIELD SERVICE LABELS (KIT P/N CEV159)



VENCO VENTURO INDUSTRIES LLC
CINCINNATI, OHIO

TITLE
TABLE OF CONTENTS
VC500FB

DATE
03-09-16
SUPERSEDES
-

SECTION
-
CEV145

SECTION 100

DESCRIPTION

&

SPECIFICATIONS

WARNING:

THESE PRODUCTS ARE NOT PASSENGER LIFTS. THEY ARE NOT DESIGNED OR INTENDED TO BE USED TO LIFT, SUPPORT OR OTHERWISE TRANSPORT PERSONNEL.

FOLDED POSITION

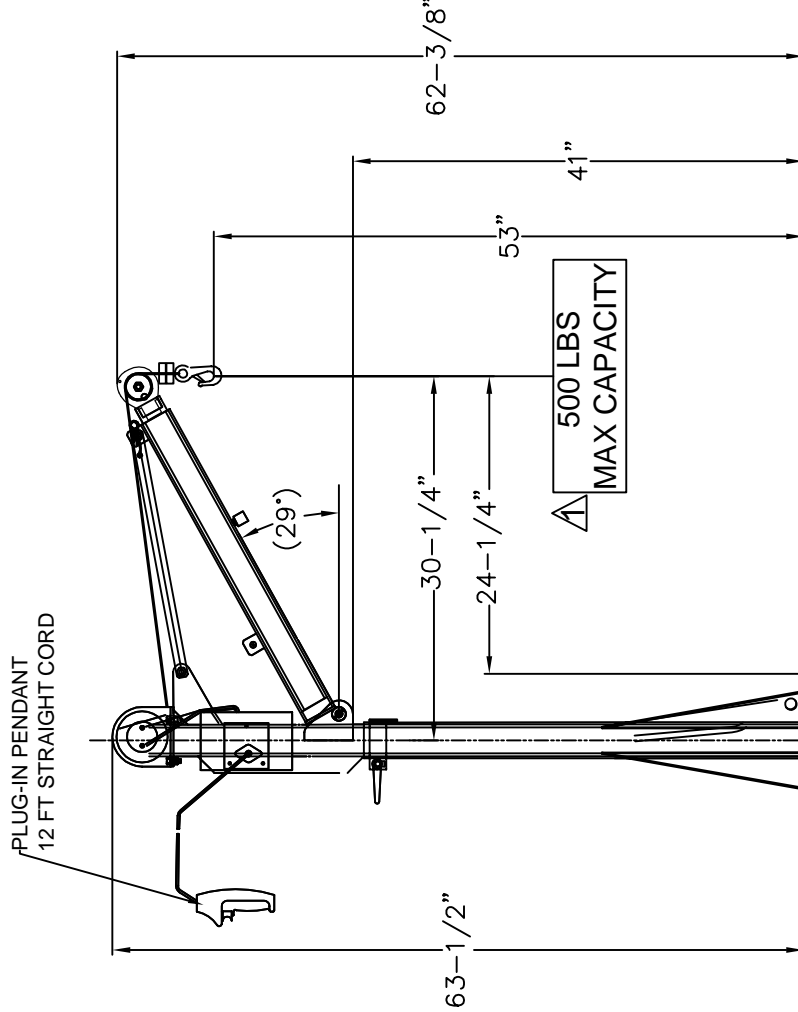
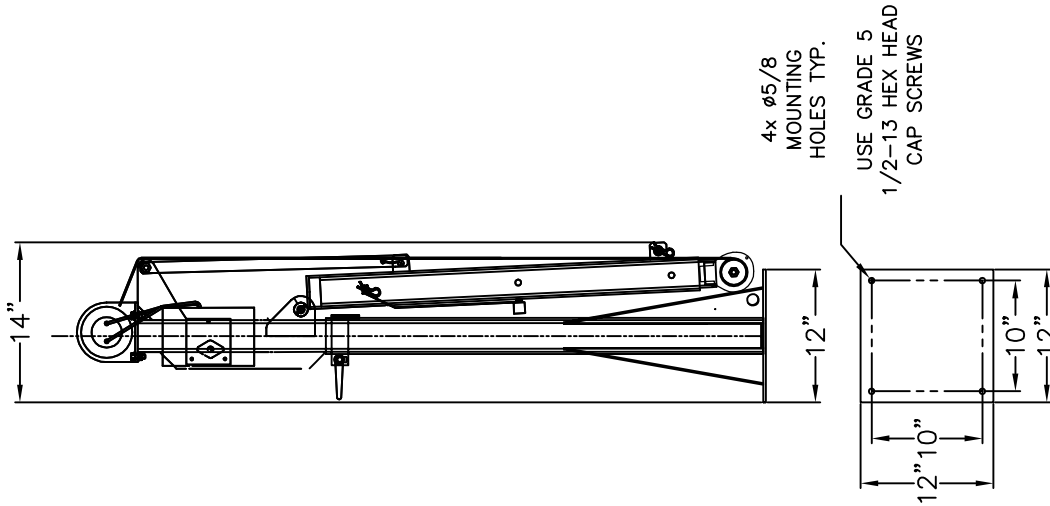

NOTE: 500LB MAXIMUM CAPACITY IS BASED UPON TYPICAL VAN FLOOR STRUCTURE LIMITATIONS, NOT WINCH CAPACITY. IT IS THE SOLE RESPONSIBILITY OF THE INSTALLER TO DETERMINE IF ADDITIONAL FLOOR REINFORCEMENT IS NECESSARY.



VENCO VENTURO INDUSTRIES LLC
CINCINNATI, OHIO

TITLE
DIMENSIONS & CAPACITY

VC500FB

DATE
03-09-16

SUPERSEDES
-

SECTION
C100

CEV146

15810-3/16-25 WIREROPE ASSEMBLY

VC500FB
TYPE: 3/16" DIAMETER
7 x 19, GALVANIZED
(GAC 7X19 LHRL-IWRC, SB 4200)
LENGTH: 25'

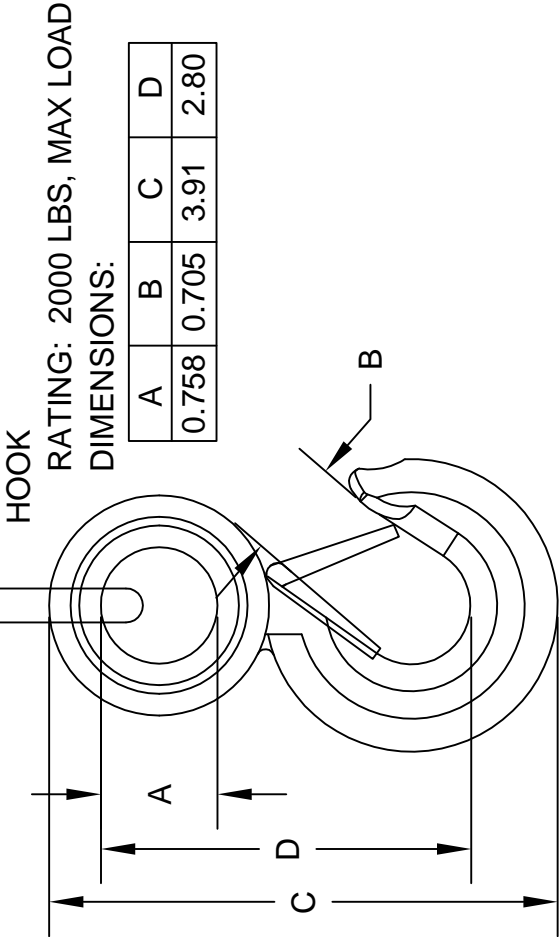

VENCO VENTURO INDUSTRIES LLC
CINCINNATI, OHIO

TITLE
WIREROPE & HOOK SPECIFICATIONS

VC500/750FB & VC1000 VAN CRANES



DATE

11-01-16D

SUPERSEDES

08-17-16C

SECTION

C100

CEV162

SECTION 150

SAFETY

CAUTIONS

1. INSPECT VEHICLE AND CRANE, INCLUDING OPERATION, PRIOR TO USE DAILY.
2. DO NOT USE THIS EQUIPMENT EXCEPT ON SOLID, LEVEL SURFACE WITH CRANE MOUNTED ON FACTORY RECOMMENDED TRUCK.
3. BEFORE OPERATING THE CRANE, REFER TO MAXIMUM LOAD (CAPACITY) CHART ON CRANE FOR OPERATING (LOAD) LIMITATIONS.
4. DO NOT OPERATE, WALK, OR STAND BENEATH BOOM OR A SUSPENDED LOAD.
5. UNPLUG PENDANT (AND OPTIONAL ELECTRIC QUICK DISCONNECT, IF ON MODEL) WHEN NOT IN USE.
6. FOR TRAVEL, BOOM MUST BE TIED DOWN IN THE STOWED POSITION.

DANGER

- THIS CRANE IS NOT A PASSENGER LIFT
- IT IS NOT DESIGNED OR INTENDED TO BE USED TO LIFT, SUPPORT, OR OTHERWISE TRANSPORT PERSONNEL.

YOU MUST NOT OPERATE THIS CRANE UNLESS :

1. YOU HAVE BEEN TRAINED IN THE SAFE OPERATION OF THIS CRANE, **AND**
2. YOU KNOW AND FOLLOW THE SAFETY AND OPERATION RECOMMENDATIONS CONTAINED IN THE MANUFACTURER'S MANUALS, YOUR EMPLOYER'S WORK RULES, AND APPLICABLE GOVERNMENT REGULATIONS. AN UNTRAINED OPERATOR SUBJECTS THEMSELVES AND OTHERS TO DEATH OR SERIOUS INJURY.



VENCO VENTURO INDUSTRIES LLC
CINCINNATI, OHIO

TITLE

CRANE SAFETY & HZRDS

CE- / CEV SERIES CRANES

DATE

08-16-16C

SUPERSEDES

05-05-98B

SECTION

C200

CE-044



DECAL #: 15390
DESCRIPTION: CAUTION, INSPECT VEHICLE & CRANE...
PURPOSE: TO INFORM THE OPERATOR OF KEY OPERATING REQUIREMENTS.
QUANTITY: 1
PLACEMENT: UPPER MAST ON SIDE, OPPOSITE PRIMARY BOOM

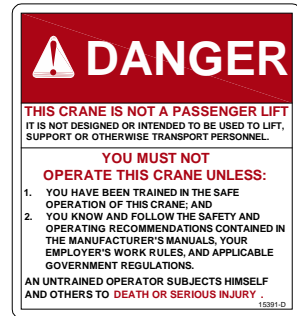

DECAL #: 15391
DESCRIPTION: DANGER, NOT A PASSENGER LIFT
PURPOSE: TO INFORM OPERATOR NOT TO LIFT, SUPPORT, OR TRANSPORT PERSONNEL, AND TO ENSURE OPERATOR IS ADEQUATELY TRAINED.
QUANTITY: 1
PLACEMENT: UPPER MAST ON SIDE, OPPOSITE PRIMARY BOOM

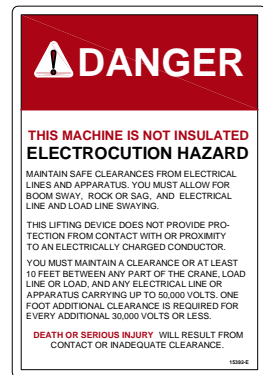

DECAL #: 15392
DESCRIPTION: DANGER, ELECTROCUTION HAZARD, MACHINE (CRANE)
PURPOSE: TO INFORM OPERATOR THAT MACHINE (CRANE) REPRESENTS AN ELECTROCUTION HAZARD SHOULD IT COME CLOSE TO OR IN CONTACT WITH AN ELECTRICAL VOLTAGE SOURCE.
QUANTITY: 1
PLACEMENT: UPPER MAST ON SIDE, OPPOSITE PRIMARY BOOM

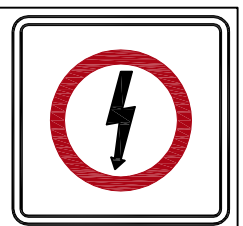
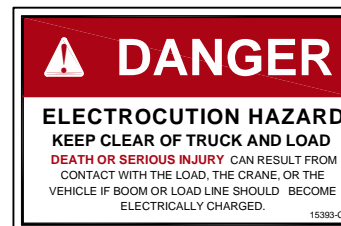

DECAL #: 15393
DESCRIPTION: DANGER, ELECTROCUTION HAZARD, VEHICLE (TRUCK)
PURPOSE: WARNS OF DANGER FROM ELECTRICALLY CHARGED VEHICLE, CRANE, OR LOAD.
QUANTITY: 4
PLACEMENT: EACH SIDE & EACH END OF VEHICLE



VENCO VENTURO INDUSTRIES LLC
CINCINNATI, OHIO

TITLE
SAFETY DECALS

VENTURO VAN CRANES

DATE
09-29-16A

SUPERSEDES
08-02-16

SECTION
C400

CEV170

DECAL #: 15513
 DESCRIPTION: MASTER DISCONNECT SWITCH
 PURPOSE: TO INFORM THE OPERATOR OF LOCATION AND OPERATION OF MASTER DISCONNECT SWITCH
 QUANTITY: 1
 PLACEMENT: ON MASTER DISCONNECT SWITCH BRACKET



DECAL #: 15398
 DESCRIPTION: UNPLUG REMOTE CONTROL
 PURPOSE: TO INFORM OPERATOR TO UNPLUG REMOTE CONTROL WHEN NOT IN USE
 QUANTITY: 1
 PLACEMENT: NEAR PENDANT SOCKET



DECAL #: 573403
 DESCRIPTION: WARNING - STOWING
 PURPOSE: TO INFORM OPERATOR TO STAY AWAY FROM THE BOOM WHEN STOWING
 QUANTITY: 1
 PLACEMENT: UPPER MAST ON SIDE, OPPOSITE PRIMARY BOOM



VENCO VENTURO INDUSTRIES LLC
 CINCINNATI, OHIO

TITLE
 SAFETY DECALS

VENTURO VAN CRANES

DATE
 09-29-16A

SUPERSEDES
 08-02-16

SECTION
 C400

CEV171

PART NO.: 15390
 DECAL: CAUTION - INSPECT VEHICLE & CRANE
 FUNCTION: To inform the operator of key operating requirements.
 QUANTITY: 1
 PLACEMENT: Top of pedestal.



PART NO.: 15398
 DECAL: UNPLUG REMOTE CONTROL
 FUNCTION: To inform the operator to unplug remote control when not in use.
 QUANTITY: 1
 PLACEMENT: Near pendant socket.



PART NO.: 15672-500
 DECAL: CAPACITY 500 LBS
 FUNCTION: To show the operator the capacity at 9 foot boom length.
 QUANTITY: 2
 PLACEMENT: One on each side of boom.



PART NO.: CEV163
 DECAL: MODEL NAME
 FUNCTION: To show the model of the crane.
 QUANTITY: 2
 PLACEMENT: One on each side of boom.



MFG., INC.
 CINCINNATI, OHIO

TITLE	DATE	SECTION
DECAL DRAWINGS & LIST	04-18-16A	C150
VC500-FB	SUPERSEDES 03-09-16	CEV147

SECTION 200

INSTALLATION



INSTALLATION INSTRUCTIONS / MINIMUM HARDWARE SPECIFICATIONS
VC500FB (VFCAAA) and VC750FB (VJCAAA) VAN CRANES

THE VC500/750FB VAN CRANES ARE DESIGNED TO BE INSTALLED IN EITHER THE RIGHT SIDE OF THE VAN NEAR THE SIDE CARGO DOOR (PRIMARY LOCATION) OR THE RIGHT REAR CORNER (SECONDARY LOCATION).
▲

!! MINIMUM HARDWARE SPECIFICATIONS !!

Reinforcement plates

It is the installer's responsibility to ensure the van's floor structure is able to withstand the stresses applied when lifting and maneuvering loads into and out of the van. Additional sub-floor plating may be required.

Bolts

The VC500/750FB mounting bolts should be 1/2" in diameter with 13 threads per inch (1/2-13), grade 5 steel zinc plated. Lengths will vary depending on crane location, vehicle structure, and / or additional reinforcement requirements.

Washers ▲

Use 1/2" flat washers. One [1] flat washer per bolt head (where applicable) and one [1] flat washer for the Nylon lock (nyloc) nut. Washers must be at grade 5 steel and zinc plated.

Nyloc Nuts ▲

Four [4] 1/2-13 nyloc nuts must be properly torqued to 75 ft. lbs. to secure the crane to the van floor.



C A U T I O N

- THE VC500FB (500 LBS.) AND VC750FB (750 LBS.) CAPACITIES ARE BASED UPON VAN'S STRUCTURAL LIMITATIONS OF THE FLOOR, NOT WINCH CAPACITY. IT IS THE INSTALLER'S RESPONSIBILITY TO ENSURE PROPER REINFORCEMENT OF VAN'S STRUCTURE TO SUPPORT THE CRANE AND ITS LOAD.

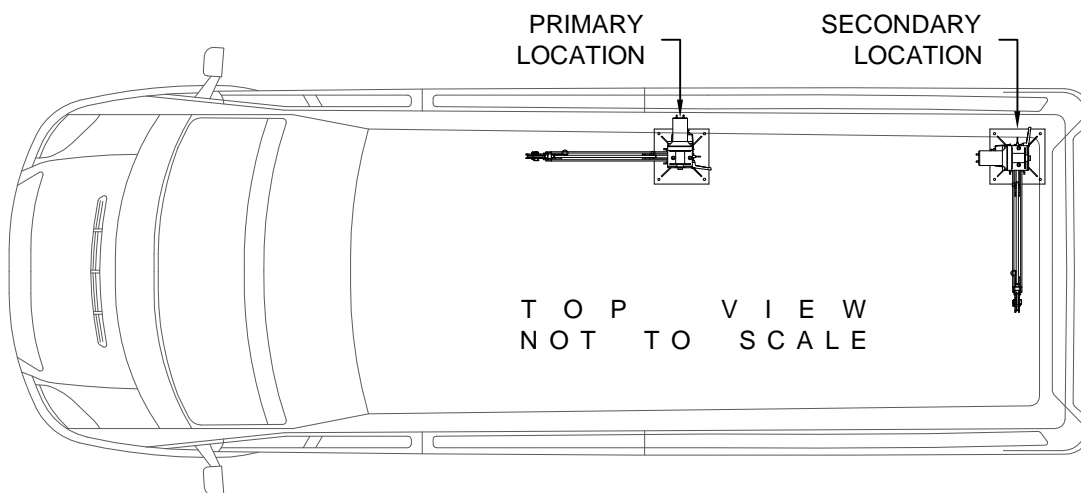

THE ILLUSTRATION ABOVE SHOWS THE GENERAL PLACEMENT OPTIONS FOR THE VC500FB AND VC750FB VAN CRANES, AND ARE TO BE USED FOR REFERENCE ONLY. SPECIFIC LOCATIONS WILL BE LIMITED BY VEHICLE STRUCTURES AND / OR INSTALLER PREFERENCE(S).



VENCO VENTURO INDUSTRIES LLC
CINCINNATI, OHIO

TITLE

INSTALL. INSTRUCTIONS

DATE

11-18-16B

SECTION

C100

VC500/750FB VAN CRANES

SUPERSEDES

10-31-16A

CEV155

- CE-008 KIT
NOTE: CE-008-D = KIT
LESS PENDANT

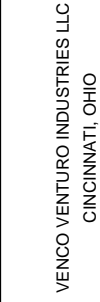

ASSEMBLY INSTRUCTIONS

Wire Rope Installation:

- 1) Remove the Hex Head Cap Screw & Nyloc nut from above the sheave on the two cheek plates.
Reinstall the Hex Head Cap Screw & Nyloc nut after the wire rope is on the sheave.

Elevating & Stowing the Boom

- 2) Remove the Quick Release Pin Assy between the Support bar and Boom Assy. to raise and lower the boom assy. Note: The boom stows vertically, parallel with the crane mast. When deployed the boom elevation is approx. 29° from level position.

STOWED POSITION

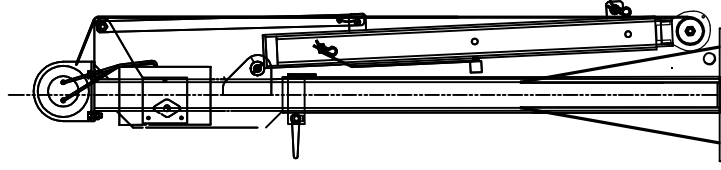
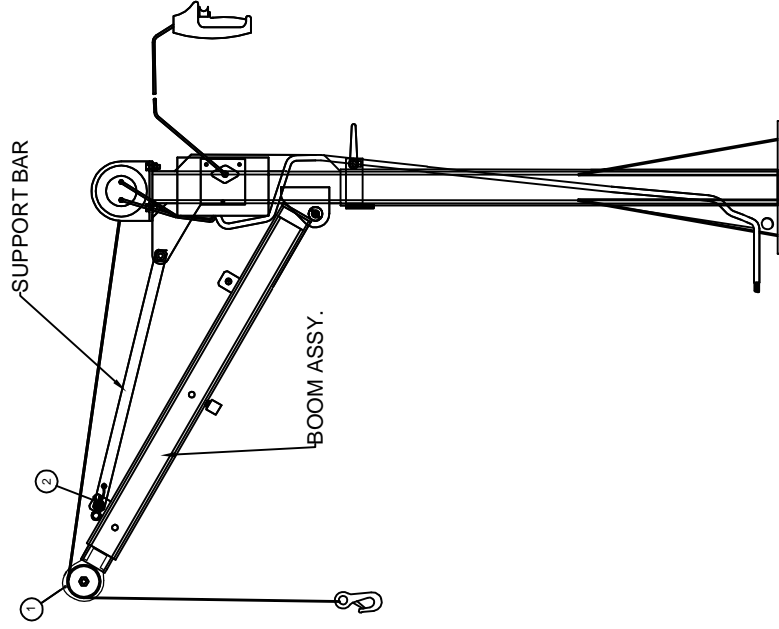

VENCO VENTURO INDUSTRIES LLC
CINCINNATI, OHIO

TITLE

ASSEMBLY INSTRUCTIONS

VC500FB

DATE

03-16-16

SUPERSEDES

-

SECTION

C200

CEV156

OPERATING INSTRUCTIONS

ELECTRIC WINCH

The winch is operated by a control switch in a plug-in remote pendant. Unplug the pendant and store it in the vehicle when the crane is not in use. For optional 110 volt AC winch, the pendant is non-removable.

ROTATION LOCK

Before lifting the load, make sure the brake handle is tightened to keep boom from rotating (do not pull items at an angle. The load hook must be centered over the load.)

BOOM TIE-DOWN

Release support bar and store crane in the folded position with pin assembly included in the support bar (See drawing CEV156).



C A U T I O N

- BOOM MUST BE FOLDED AND SECURED (STOWED POSITION) BEFORE DRIVING VEHICLE. DO NOT DRIVE WITH BOOM EXTENDED OUT.

MASTER DISCONNECT SWITCH

The Master Disconnect Switch isolates electrical power from the crane and should be switched OFF anytime the crane is NOT in use.

OPTIONAL CIRCUIT BREAKER

An optional 150amp circuit breaker (#22964-150) is available. The circuit breaker should be placed between the lead-acid battery supply and the crane; **as close as practical to the lead-acid battery.**

MAINTENANCE

WINCH

The winch is permanently lubricated. There may be grease leakage out of the winch, especially during the first few operations. This is normal and it is not necessary to grease or oil any part of the winch at any time.

WIRE ROPE

Inspect wire rope periodically. If any wear or fraying exists, replace wire rope.



VENCO VENTURO INDUSTRIES LLC
CINCINNATI, OHIO

TITLE

OPER. INSTR. & MNTNCE

DATE

11-01-16A

SECTION

C200

SUPERSEDES

03-14-16

VC500/750FB

CEV150

SECTION 400

PARTS



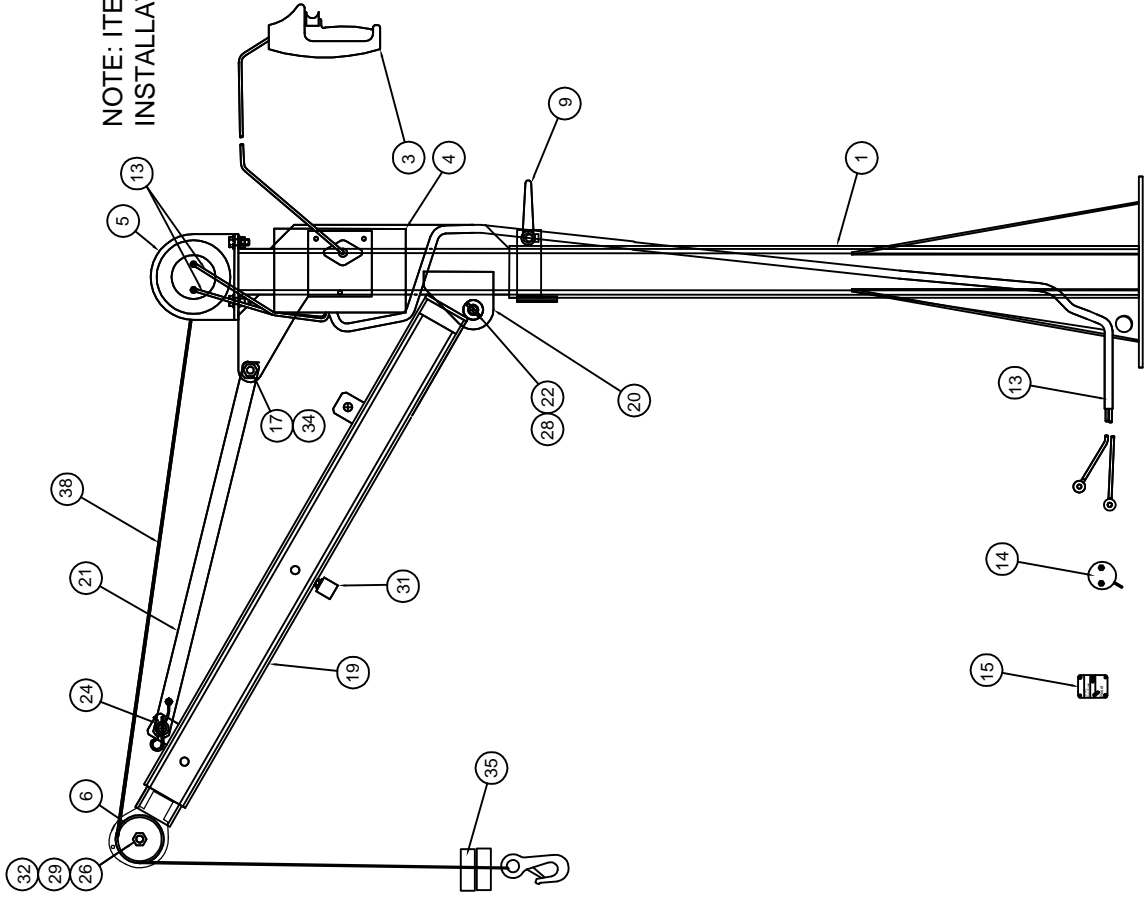

NOTE: ITEM 13 REPRESENTS A CABLE SET. SEE
INSTALLATION PAGE CE-022 FOR MORE INFO.

* SEE REPLACEMENT PARTS LIST CEV161

<div> VENCO VENTURO INDUSTRIES LLC CINCINNATI, OHIO</div>	TITLE		SECTION
	REPLACEMENT PARTS DRAWING		C400
	VC500FB		CEV160
		DATE	
		03-17-16	
		SUPERSEDES	
		-	

VC500FB
REPLACEMENT PARTS LIST

ITEM	PART NUMBER	QTY	DESCRIPTION
1	CE-002-4	1	BASE ASSEMBLY
2	-	-	-
3	CE-006	1	PENDANT
4	CE-008	1	REMOTE KIT
5	CE-009	1	WINCH (MODEL X1, REF P/N 1102C)
6	19646	1	SHEAVE WITH BUSHING
7	-	-	-
8	-	-	-
9	CE-017	1	BRAKE HANDLE
10	-	2	MOUNTING CHANNEL
11	-	-	-
12	-	-	-
13	90-23339-10	1	CABLE SET, # 8GA, RED & BLACK CABLES (REF. PAGE CE-022)
14	13451	1	MASTER DISCONNECT SWITCH
15	22964-150	1	(OPTIONAL) CIRCUIT BREAKER, 150AMP, MANUAL RESET / TRIP
16	-	-	-
17	!LNUT-05013	1	LOCK NUT, NYLON, 1/2-13
18	-	-	-
19	CEV153	1	PRIMARY BOOM, WELDED ASSEMBLY
20	CE-059-2	1	UPPER BODY ASSEMBLY
21	CEV148	1	SUPPORT BAR
▲ 22	CEV165	1	CLEVIS PIN, Ø1/2" X 4" LONG W/ 3-3/4" USEABLE LENGTH, PLATED
23	-	-	-
24	CE-071	1	PIN ASSEMBLY; SUPPORT BAR
25	-	-	-
26	!HHCS06311150	1	HEX HEAD CAP SCREW; 5/8-11 X 1-1/2 LONG
▲ *27	!FWSH-050SAE	2	FLAT WASHER, SAE, 1/2" PLATED, FOR PRIMARY BOOM PIVOT PIN
▲ 28	416554	1	RUE-RING COTTER
29	!JNUT-06311-N	1	NYLON LOCK NUT; 5/8-11
30	PL-20-259	3	6" WIRE TIE
31	PL-20-364	1	BUMPER
32	13168-7	1	SLEEVE
33	-	-	-
34	!HHCS05013150	1	HEX HEAD CAP SCREW; 1/2-13 X 1-1/2 LONG, GR. 5
35	16735	1	HEADACHE BALL ASSY. (6.9LBS)
*36	CEV159	1	FIELD SERVICE LABEL KIT
37	-	-	-
38	15810-3/16-25	1	WIRE ROPE & HOOK ASSEMBLY

* = NOT SHOWN



VENCO VENTURO INDUSTRIES LLC
CINCINNATI, OHIO

TITLE

REPLCMNT PART LIST

VC500FB

DATE

04-25-16A

SUPERSEDES

03-17-16

SECTION

C400

CEV161

REPLACEMENT PARTS LIST

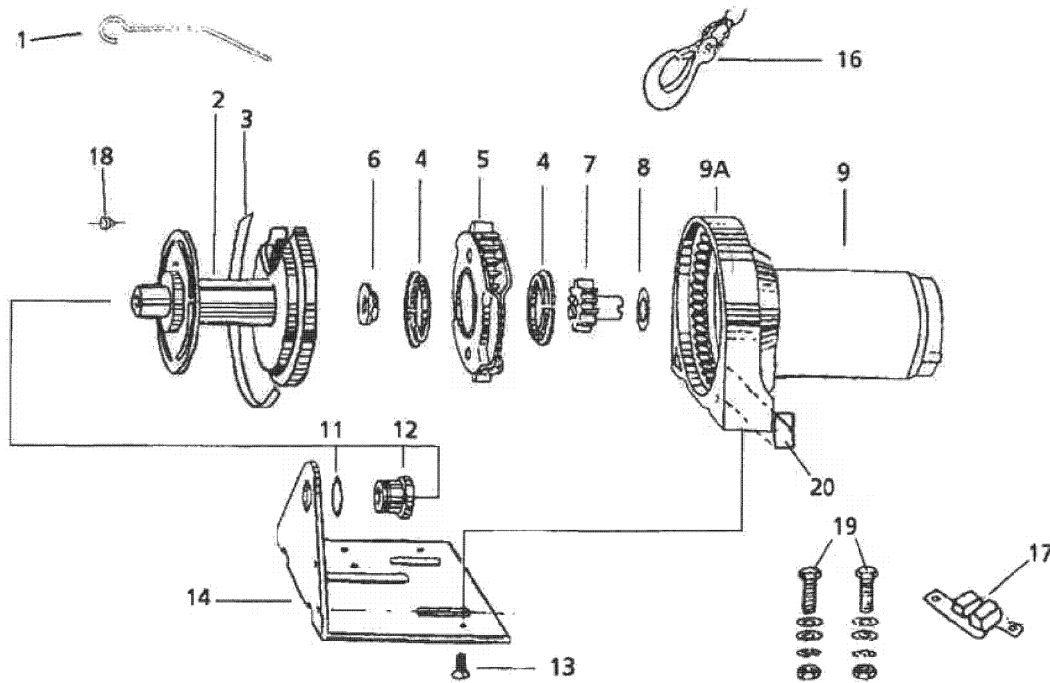

Reference Number	Description	Part Number	Qty
1	Handsaver	89-32300	1
2	Rotating Gear Drum	90-32038	1
3	Perimeter Bearing	90-23137	1
4	Carrier Bearing	90-23140	2
5	Planetary Gearing Assembly	90-23138	1
6	Nylon Step Washer	90-12418	1
7	10-Tooth Sun Gear	90-22865	1
8	Flat Thrust Washer	90-23120-08	1
9A	Stationary Ring Gear w/ Needle Bearing	90-12629	1
9	12 Volt Motor w/Ring Gear & Needle Bearing	90-32425	1
	12 Volt Motor (external mtg bolt applications only)	90-33293	1
11	Shim Washer	90-23120-05	AR
12	Bushing	90-12174	1
13	5/16" Socket Head Cap Screw	90-23056-02	2
14	Main Frame Base Plate	90-41019	1
16	3/16" x 25' Cable & Hook Assembly	1511	1
17	12V Circuit Breaker Assembly	90-22873	1
18	Rope Retainer	90-12419	1
19	Pair of 3/8" Bolts & Nuts, 4 Flat Washers & 2 Locking Washers	90-22892	1
20	Handsaver Label	90-12417	1
NS	Pulley Block	2227	1

AR denotes "As Required"



VENCO VENTURO INDUSTRIES LLC
CINCINNATI, OHIO

TITLE
WINCH REPLCMNT PARTS

CE-1500-FB & CEV SERIES

DATE
08-18-16D

SUPERSEDES
11-11-09C

SECTION
C400

CE-055



17389-4

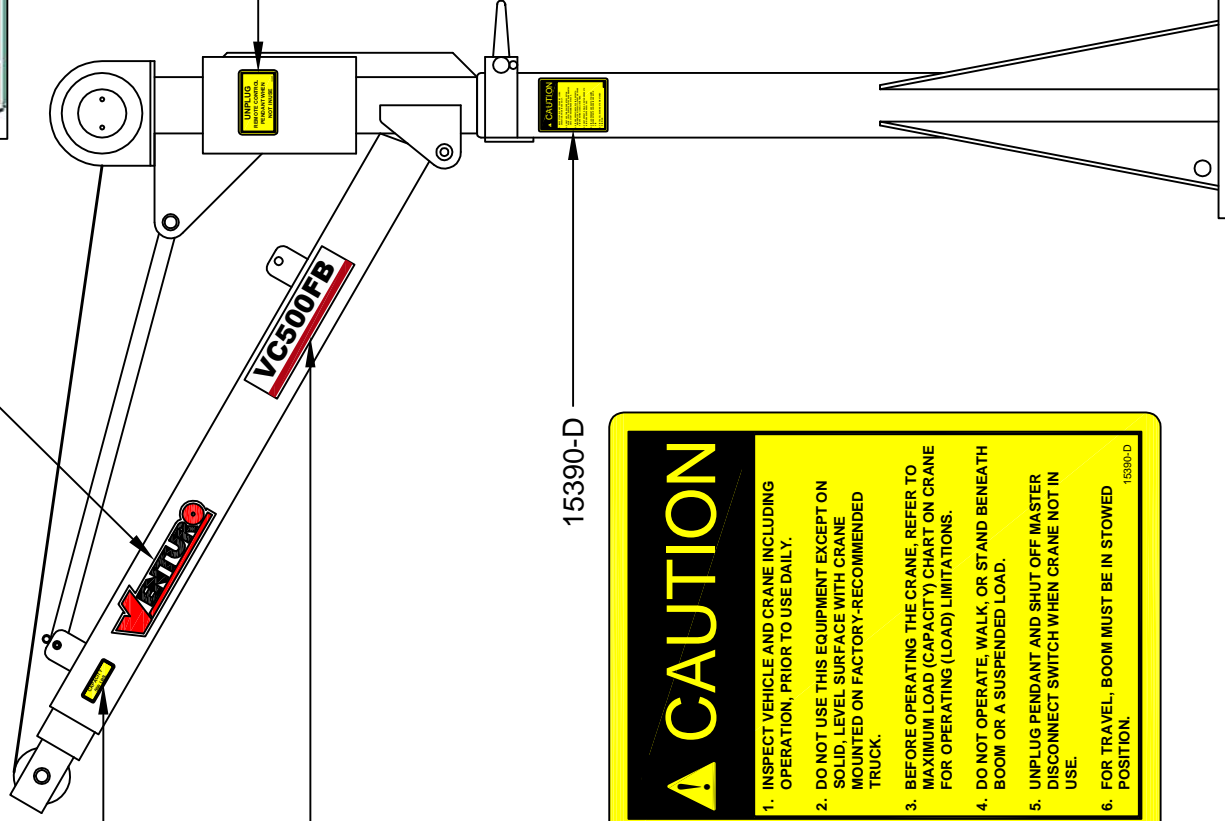

15672-500-E



CEV163

15398-F



15390-D

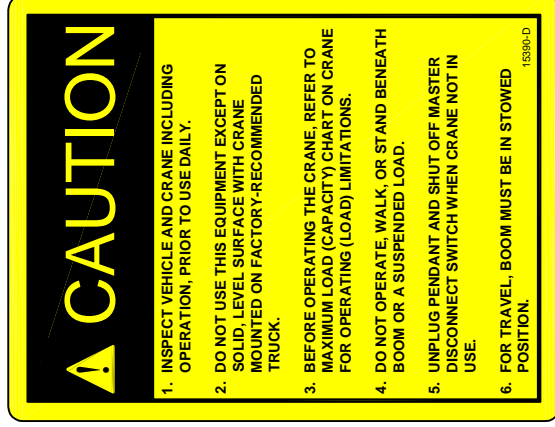

NOTE:

CAPACITY DECALS AND VENTURO LOGO DECALS MUST BE PLACED ON BOTH SIDES OF THE PRIMARY BOOM.



TITLE
DECAL LOCATIONS
VC500FB

DATE
04-19-16A
SUPERSEDES
03-16-16

SECTION
C400
CEV157

ITEM NO.	PART NO.	QTY	DESCRIPTION
1	15397	1	BOM, ACCIDENT PREVENTION SIGNS
2	17389-4	2	VENTURO DECAL (SMALL)
3	15672-500	2	CAPACITY DECAL - 500LBS
4	CEV163	2	DECAL, MODEL, VC500FB
5	CEV158	1	IDWG: FIELD SERVICE LABEL KIT

15397 ACCIDENT PREVENTION SIGNS		
PART NO.	QTY.	DESCRIPTION
15390	1	DECAL; CAUTION, OPERATIONS
15391	1	DECAL; DANGER, NOT PASSENGER LIFT
15392	1	DECAL; DANGER, ELECTRICAL HAZARD SIGN
15393	4	DECAL; DANGER, ELECTRICAL HAZARD
15394	1	APPLICATION INSTRUCTIONS
15398	1	DECAL; UNPLUG PENDANT
15401	1	DECAL; UNLAWFUL TO OPERATE
15513	1	DECAL; MASTER DISCONNECT
22317	1	DECAL SHEET; VENTURO, COMPLEMENTARY
20927	1	DECAL; CRANE STABILITY



VENCO VENTURO INDUSTRIES LLC
CINCINNATI, OHIO

TITLE	DATE	SECTION
FIELD SERVICE LABEL KIT	08-23-16B	C400
VC500FB	SUPERSEDES	CEV158
	04-18-16A	



VENTURO CRANES LIMITED WARRANTY POLICY

Venturo products are built to last...we guarantee them.

As a purchaser of any new Venturo product covered by warranty, you will receive 1 year of the most complete coverage available...and, at no added cost to you.

1-Year Limited Warranty Policy

This limited policy warrants new products of Venturo to be free from defects in material and workmanship for a period of one (1) year from date of original installation. OEM products or accessories purchased by Venturo as part of or offered with our product will carry the OEM manufacturer's respective warranty. Our warranty covers:

- ***Repair or replacement of product***
- ***Labor to repair or replace product***
- ***Freight to return and/or replace product***

We shall not be liable for any contingent liabilities arising out of the improper function of any products. Warranty shall become void if the product is improperly installed, modified, damaged, abused or used for application other than intended use. There is no warranty of merchantability, fitness for a particular purpose, warranty arising from course of dealing or usage of trade, or any other implied or expressed warranty, except as made specifically herein. This warranty supersedes all previous warranties, written or implied.

Warranty Claims

Venco Venturo Industries LLC will make a good faith effort for prompt correction or other adjustment with respect to any product, which proves to be defective after our inspection and within the warranty period. Before any repairs are attempted or before returning any product, your Venturo Distributor is required to obtain a warranty claim number. This number is necessary for any claim to be considered. To obtain a warranty claim number, Venturo requires the model and serial number. Only authorized Venturo Distributors can perform warranty. For the name and address of your local Venturo Distributor call the **Warranty Claim Department - 513-772-8448**.

WARNING - It is the responsibility of the installer to ensure the installation is completed according to the manufacturer's recommendations, ensure the ultimate user understands how to operate product in a safe manner, and understands the need for regular service and maintenance by an authorized Venturo Distributor. No modifications or alterations may be made to any Venturo product without the expressed written consent of Venco Venturo Industries LLC. Installation of any Venturo product must be done by an authorized Venturo Distributor, to the standards of the industry; including maintenance, service and affixing of all instruction, safety and warning decals. Users should be instructed as to the safe operation at time of delivery. Maintenance, service, operation and safety warning decals are available on request from Venco Venturo Industries LLC.

VENCO VENTURO INDUSTRIES LLC
12110 BEST PLACE | CINCINNATI, OHIO 45241
P: 800-226-2238 | F: 513-326-5427
www.venturo.com